



**Woodhaven-Brownstown School District**  
24821 Hall Road  
Woodhaven, MI 48183  
734-783-3300 734-783-3316 Fax

**May 27, 2011**

**Bid Specifications:**

**Brownstown Middle School** – Corridor Carpet Replacement, Resilient Base, Transitions  
Located at 20135 Inkster Road, Brownstown, MI 48174-9476

**Furnish and install the following:**

3 Corridors per schematic

**Approximately 4,500 sq. feet.**

Tandus 6 ft Crayon Outside the Lines Powerbond

Demo existing carpet tile and wall base, properly  
Dispose of off site  
Skim/prep floor as required  
Install new Tandus carpeting  
Install new 4' vinyl wall base  
Install Transitions from carpet to hard surface (see attached)

- Building is available for 2<sup>nd</sup> and 3<sup>rd</sup> shift work.
- Project may be started on June 16, 2011
- Project completion date by September 2, 2011
- Contractor is responsible to verify all measurements for project.
- Mandatory walk thru at Brownstown Middle School on June 1, 2011 at 9:00 a.m.
- Questions and inquiries until Monday, June 6, 2011.

Contact Neil Greene, Director of Support Services, at 734-783-0806, ext. 1080 with all inquiries.

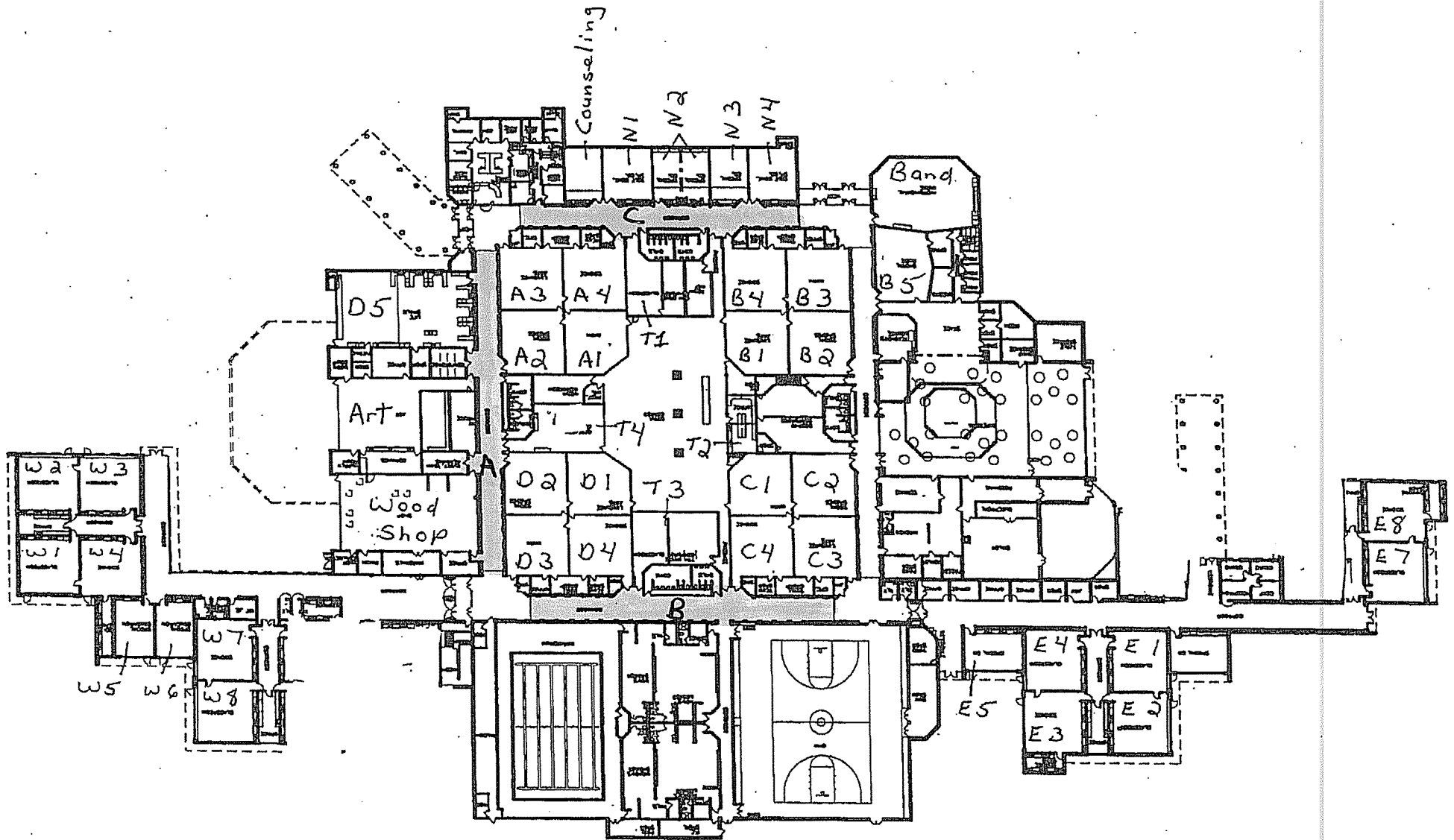

BROWNSTOWN MIDDLE SCHOOL

WHEELED TROPICAL TRANSITIONS

<p><b>CTA-XX-H</b> Patented 1/4" to 1/8" material.</p>	
<p><b>CTA-XX-HL</b> Patented 1/4" to 1/8" material.</p>	
<p><b>CTA-XX-HT</b> Patented 1/4" to .080" or 2 mm material.</p>	
<p><b>CTA-XX-J</b> 1/4" material to subfloor.</p>	
<p><b>CTA-XX-JL</b> 1/4" material to subfloor.</p>	
<p><b>CTA-XX-K</b> Patented 3/8" to 1/8" material.</p>	
<p><b>CTA-XX-L</b> Patented 3/8" to 1/4" material.</p>	
<p><b>CTA-XX-M</b> 1/4" to 1/4" material.</p>	
<p><b>CTA-XX-N</b> 1/8" to 1/8" material.</p>	
<p><b>CTA-XX-P</b> 3/8" material to subfloor.</p>	
<p><b>CTA-XX-PL</b> 3/8" material to subfloor.</p>	
<p><b>CTA-XX-Q</b> 1/2" material to subfloor.</p>	
<p><b>CTA-XX-X</b> .080" to 1/8" material.</p>	
<p><b>CTA-XX-Y</b> .080" to .080" material.</p>	
<p><b>CTA-XX-Z</b> 3/8" to .080" material.</p>	

U.S. Patent No. 5,581,967

FLEXIBLE VINYL CORNER GUARDS

Johnsonite's corner guards will not only complement the interior space, but also work to protect your finished design.

- Will not shrink, crack or chip
- 4 return sizes: 2-3/8", 1-1/2", 3/4" and 1-1/4"

FLEXIBLE VINYL CORNER GUARDS

**VBG-XX-B-48**  
**VBG-XX-B-96**  
4' or 8' pieces

Corner guard.  
3/4" returns.  
1/8" thick.  
Tapered ends.



**VBG-XX-A-48**  
**VBG-XX-A-96**  
4' or 8' pieces

Corner guard.  
1-1/2" returns.  
1/8" thick.  
Tapered ends.

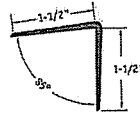

**VBG-XX-48**  
**VBG-XX-96**  
4' or 8' pieces

Corner guard.  
2-3/8" returns.  
1/8" thick.  
Tapered ends.

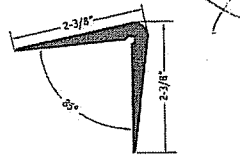

**VBG-XX-C**  
8' pieces

Millwork profile corner guard.  
1-1/4" returns.  
1/4" thick.

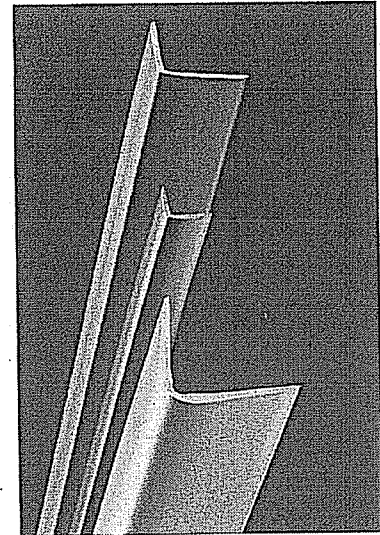
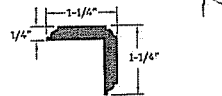

For representation of actual size, enlarge CAD drawing 333 percent on a photocopier.

ADHESIVES PG. 114  
SPECIFICATIONS PG. 121

- Also available in 14 Tropical Storm, 15 Cabernet, 60 Taupe and 132 Espresso.
- ◆ Available in Selects Color Palette. Unfold color guide on last page.

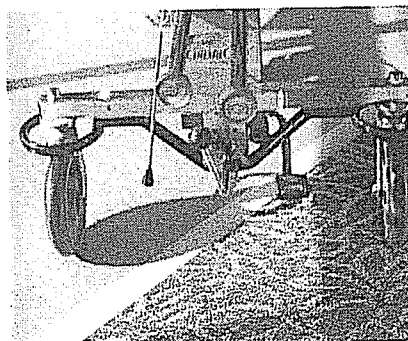

For available colors, reference color palette A on last page.  
A +14 Tropical Storm, 15 Cabernet, 60 Taupe, 129 Silk, 132 Espresso, 150 Wetlands and 167 Fudge.